

SCREWDRIVERS: OVERVIEW

TORQUE CONTROL AUTOMATIC SHUT-OFF TYPE

- Precise repeatability to improve quality
- Very little wear on internal parts for long life
- Quick shut-off for minimum torque reaction
- Choices of speeds for flexibility
- External simple torque adjustment
- Midrange air motor provides high speed during entire cycle
- Best choice for industrial torque control applications



CUSHION CLUTCH TYPE

- Good general duty screwdriver
- High speed rundown
- Clutch ratchets at preset torque
- Internal torque adjustment
- General assembly, wood and sheet metal screws

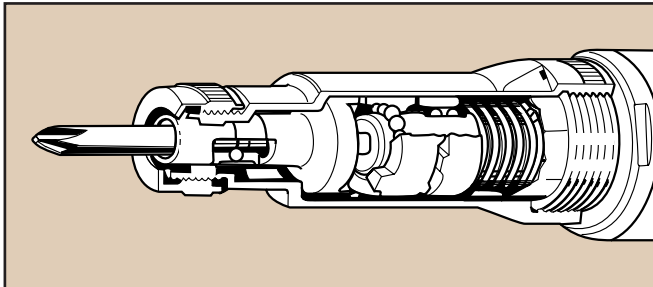

POSITIVE CLUTCH TYPE

- Good for varying torque applications
- Clutch ratchets at preset torque
- Operator can force clutch engagement for higher torque
- Good for prevailing torque applications

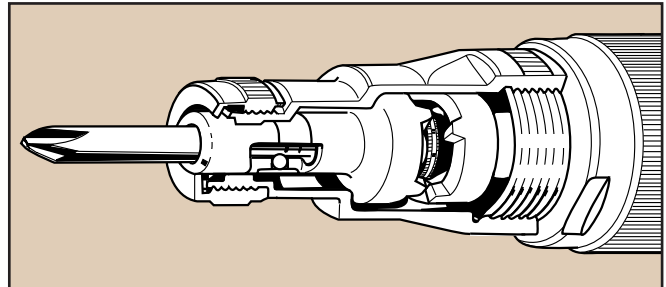

IMPACT TYPE

- High power-to-weight ratio
- Fast cycles times with free speeds up to 16,000 rpm
- Great for non-critical applications

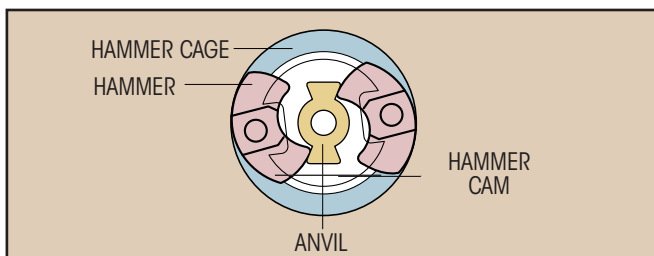

DIRECT DRIVE

- Air motor directly drives the gears
- Stall torque dependent on air pressure
- Simple maintenance
- Lightest and smallest air screwdriver
- Good for soft draw applications such as wood screws, self-tapping screws, or trim screws

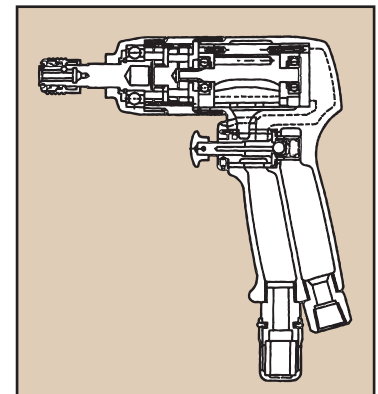

Only 12% of tightening energy is used to create **clamp load** in a joint. The other 88% of the tightening energy is consumed by friction of the threads and fastener head mating with the joint components.



US-LT50B

US-LT30B-11

- 1 Tool Hanger
- 2 Muffled Exhaust
- 3 Push Button Lockable Reverse
- 4 Foam Grip
Standard with all models
- 5 Simple Torque Adjustment
- 6 Compact Bit Holder
- 7 Thousands of Bits and Sockets available
Contact AIMCO for more information

Torque Control Light Touch (LT) Series – Push-to-Start Type Inline

Recommended Air Pressure: 85 psi

MODEL	TORQUE RANGE		FREE SPEED rpm	OVERALL LENGTH		WEIGHT		FROM CENTER TO OUTSIDE		NOISE LEVEL dB(A)	AIR USAGE cfm
	Nm	in-lb		mm	in	lb	kg	mm	in		
US-LT10B	0.20 - 0.60	1.8 - 5.3	1,000	190	7.5	0.6	0.3	12	0.5	75	5.2
US-LT20B-10	0.15 - 1.10	1.3 - 9.7	1,000	180	7.1	0.7	0.3	13	0.5	70	5.6
US-LT20B-18	0.15 - 0.70	1.3 - 6.2	1,800	180	7.1	0.7	0.3	13	0.5	70	5.6
US-LT20B-26	0.15 - 0.35	1.3 - 3.1	2,600	180	7.1	0.7	0.3	13	0.5	70	5.6
US-LT30B-11	0.40 - 2.10	3.5 - 18.5	1,100	187	7.2	0.9	0.4	16	0.6	70	7.0
US-LT30B-17	0.40 - 1.50	3.5 - 13.0	1,700	187	7.2	0.9	0.4	16	0.6	70	7.0
US-LT30B-23	0.40 - 1.00	3.5 - 8.7	2,300	187	7.2	0.9	0.4	16	0.6	71	7.0
US-LT40B-08	1.00 - 4.00	8.7 - 34.7	800	209	8.2	1.4	0.6	17	0.6	70	10.5
US-LT40B-15	1.00 - 2.20	8.7 - 19.1	1,500	209	8.2	1.4	0.6	17	0.6	70	10.5
US-LT40B-21	1.00 - 1.70	8.7 - 14.8	2,100	209	8.2	1.4	0.6	17	0.6	74	10.5
US-LT50B-05	1.50 - 10.50	13.2 - 92.4	480	240	9.4	2.2	1.0	20	0.8	74	17.5
US-LT50B-08	1.50 - 5.50	13.2 - 48.4	800	240	9.4	2.2	1.0	20	0.8	75	17.5
US-LT50B-17	1.50 - 2.50	13.2 - 23.0	1,700	240	9.4	2.2	1.0	20	0.8	75	17.5

Each model is equipped with its standard and alternate clutch springs.

Additional clutch springs specifications to provide the full torque range of each model on page 28.

Air Hose Size: 1/4" I.D. for US-LT10B - US-LT40B Series

Air Inlet: 1/8" for US-LT10B - US-LT20B Series

3/8" I.D. for US-LT50B Series

1/4" for US-LT30B - US-LT50B Series



See also: AUET/MTM DESKTOP TESTERS

on page 84

PNEUMATIC SCREWDRIVERS



US-LT30BL SERIES
US-LT40BL SERIES

US-LT30B-11C

Torque Control Light Touch (LT) Series – Angle and Lever

Recommended Air Pressure: 85 psi

MODEL	TORQUE RANGE (SOFT JOINT)		FREE SPEED rpm	OVERALL LENGTH		WEIGHT		FROM CENTER TO OUTSIDE		HEX BIT OR DRIVE SIZE in	NOISE LEVEL dB(A)	AIR USAGE cfm
	Nm	in-lb		mm	in	lb	kg	mm	in			
ANGLE												
US-LT30B-11C	0.39 - 2.10	3.5 - 18.5	1,100	298	10.7	1.5	0.7	10	0.4	1/4	73	7.0
US-LT30B-17C	0.39 - 1.50	3.5 - 13.2	1,700	295	10.7	1.5	0.7	10	0.4	1/4	73	7.0
US-LT40B-05C	2.26 - 5.60	20.0 - 49.5	500	322	13.0	2.1	0.9	13	0.5	1/4	75	10.5
US-LT40B-08C	0.98 - 3.92	8.7 - 34.7	800	320	12.8	2.0	0.9	10	0.4	1/4	75	10.5
US-LT40B-15C	0.98 - 2.20	8.7 - 19.4	1,500	320	12.8	2.0	0.9	10	0.4	1/4	75	10.5
US-LT40-03C	4.90 - 9.80	43.4 - 86.8	300	360	14.2	2.4	1.1	13	0.5	1/4 Sq.	72	10.5
US-LT40-05C	2.26 - 5.70	20.0 - 50.2	500	322	13.0	2.1	0.9	13	0.5	1/4 Sq.	75	10.5
US-LT40-08C	0.98 - 3.92	8.7 - 34.7	800	320	12.8	2.0	0.9	10	0.4	1/4 Sq.	75	10.5
US-LT40-15C	0.98 - 2.06	8.7 - 18.2	1,500	320	12.8	2.0	0.9	10	0.4	1/4 Sq.	75	10.5
LEVER												
US-LT30BL-11	0.39 - 2.10	3.5 - 18.5	1,100	229	8.2	1.2	0.5	15	0.6	1/4	70	7.0
US-LT30BL-17	0.39 - 1.47	3.5 - 13.0	1,700	229	8.2	1.2	0.5	15	0.6	1/4	70	7.0
US-LT30BL-23	0.39 - 0.98	3.5 - 8.7	2,300	229	8.2	1.2	0.5	15	0.6	1/4	71	7.0
US-LT40BL-08	0.98 - 4.00	8.7 - 35.2	800	249	9.1	1.5	0.7	17	0.7	1/4	70	10.5
US-LT40BL-15	0.98 - 2.20	8.7 - 19.4	1,500	249	9.1	1.5	0.7	17	0.7	1/4	70	10.5
US-LT40BL-21	0.98 - 1.70	8.7 - 15.0	2,100	249	9.1	1.5	0.7	17	0.7	1/4	74	10.5

Angle Head Height: 32 - 36mm

Air Inlet: N.P.T. 1/4"

Air Hose Size: 1/4" I.D. for all models



See also: **AUDITOR™ TORQUE CUBE™**
on page 83