



AW Company

## TR-1100 Series Turbine Flowmeter



### Engineering Specifications:

- Flow ranges 0.6 to 5,000 GPM
- Accuracy  $\pm 1\%$  of actual flow
- Pressure rating up to 5000 PSI
- Magnetic Pickup
- Thirteen flow ranges available
- 316 Stainless Steel body
- 416 Stainless Steel rotar
- Easy maintenance design

### **What is a TR-1100 Turbine flow meter?**

The TR-1100 series turbine flow meter is designed and constructed for reliable flow measurement in laboratory and class environments. The tungsten carbide bearing design provides accurate and repeatable measurements of water and other low viscosity materials. The TR-1100 features a magnetic pickup - the MG-300 and the JV-400 signal amplifier. Optional features include meter mounted displays and mA and voltage signals.



AW Company

# TR-1100 Series Turbine Flowmeter

## Meter Technical Data

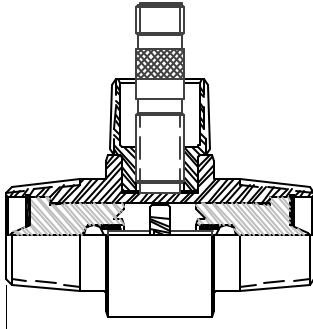

**Materials of Construction:**  
**Body:** #316 Stainless Steel  
**Rotor:** #416 Stainless Steel  
**Rotar Shaft:** Tungsten Carbide  
**Rotar Support:** #316 Stainless Steel

**Standard End Fittings:**  
 Male NPT < 2"  
 Grooved End: Victaulic ≥ 3"

**Optional End Fittings:**  
 ANSI Flange: Carbon & Stainless Steel  
 ANSI Flange Wafer Style

**Accuracy:** ± 1% of actual reading  
**Turn Down Ratio:** 10:1  
**Repeatability:** ± 0.1%  
**Temperature:** -150° F to 450° F

### MG-300 Magnetic Pickup Sensor

#### Material of Construction:

**Body:** 303/304 Stainless Steel  
**Temperature rating:** -150°F to 300°F  
**High Temperature Sensor:** MG-450 to 450°F  
**Coil Resistance:** 1.5 Kohm ±10%  
**Output Voltage:** 30mV to 3.0V

Part Number	Flow Range - GPM	Line Size	Pulse / GPM	End Connections	Pressure Rating
TR-11.375	0.6 to 3.0	1/2 " or 1"	20,000	1 x 1" male NPT	5,000
TR-11.500	.75 to 7.5	1/2 " or 1"	13,000	1 x 1" male NPT	5,000
TR-11.750	2 to 15	1/2 " or 1"	2,750	1 x 1" male NPT	5,000
TR-11.875	3 to 30	1"	2,687	1 x 1" male NPT	5,000
TR-1110	5 to 50	1"	870	1 x 1" male NPT	5,000
TR-1115	15 to 180	1 1/2"	330	1 1/2" x 1 1/2" male NPT	5,000
TR-1120L	15 to 180	2"	330	2 x 2" male NPT	5,000
TR-1120	40 to 400	2"	52	2 x 2" NPTF	5,000
TR-1130	60 to 600	3"	57	Grooved End	800
TR-1140	100 to 1,200	4"	29	Grooved End	800
TR-1160	200 to 2,500	6"	7	Grooved End	800
TR-1180	250 to 3,500	8"	3	Grooved End	800
TR-1100	500 to 5,000	10"	1.6	Grooved End	800

Products may be subject to change without notice - Contact factory for current information

The display used with the sensor must detect an input signal down to 30 mVolts or amplification will be needed. In such cases we recommend the following amplifier options: JV-400/AW Signal Amplifier Module or use JV-400/E or JV-400/EX meter mounted amplifier.

**RT-Ex2 Indicator:**  
Explosion proof housing

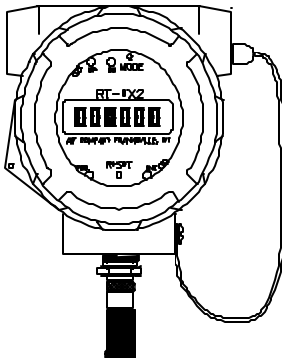

**JV-400/E or /EX:**  
Pickup with integrated amplifier

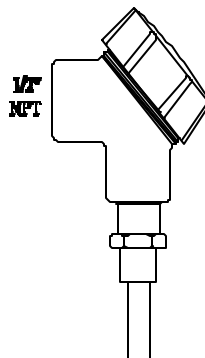

**FIP-Frequency to Analog Converter:**

40-20 mA, 0-20 mA  
 1-5 V, 0-5 V  
 2-10 V, 0-10 V  
 EX Housing

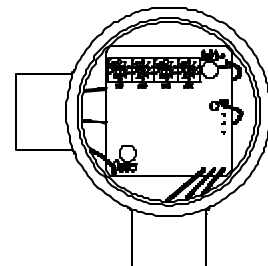

8809 Industrial Drive, Franksville, WI 53126 Phone: (262) 884-9800 Fax: (262) 884-9810

Email: aw@awcompany.com www.awcompany.com