

Quincy® QSPC Steady Pressure™ Control

Convenient, dual digital display shows both actual system pressure and pressure set point

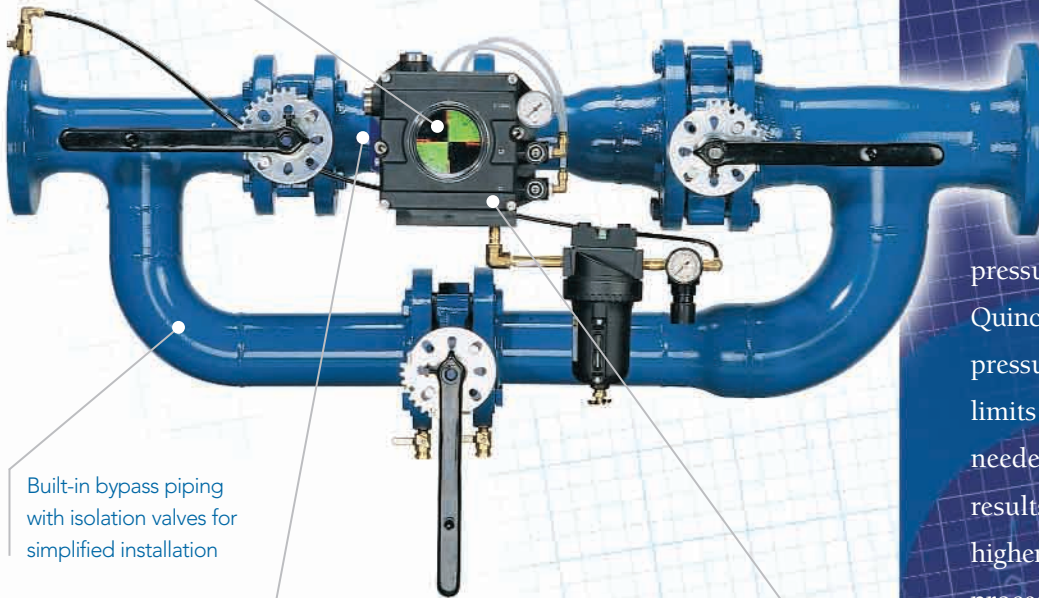

Large, color-coded valve position indicator



Built-in bypass piping with isolation valves for simplified installation

1 psi or less pressure drop at highest flow rating for maximum efficiency

Large, fail-open, single valve design for maximum reliability

Most plants strive to operate their compressed air system at elevated pressures – to protect against periods of peak air demand that cause the plant pressure to fall. As a result, the header pressure fluctuates widely causing problems with production equipment and processes. The Quincy QSPC Steady Pressure™ Control is a highly engineered pressure/flow controller, designed to put an end to fluctuating header pressure.

The Quincy QSPC has the unique ability to automatically fine tune itself to optimize plant pressure. This means that the Quincy QSPC steadies plant header pressure, reduces air usage, and limits the number of compressors needed on-line – all of which results in increased production, higher quality products, improved process control, and reduced operating costs.

Quincy Compressor®

Quincy Systems

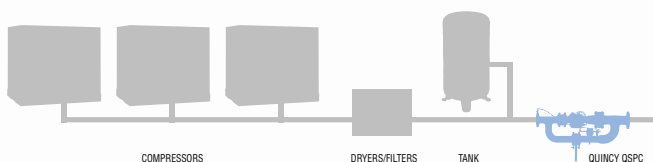

See how Quincy Compressor can work for you.

Call: 217.222.7700

Nearest Distributor: 888.4-AIR-QCY (888.424.7729)

E-mail: systems@quincycompressor.com

Discover: www.quincycompressor.com

Quincy® QSPC

Steady Pressure™ Control

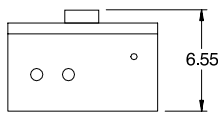
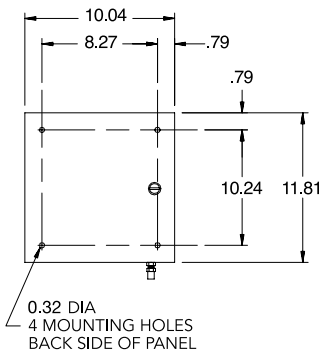
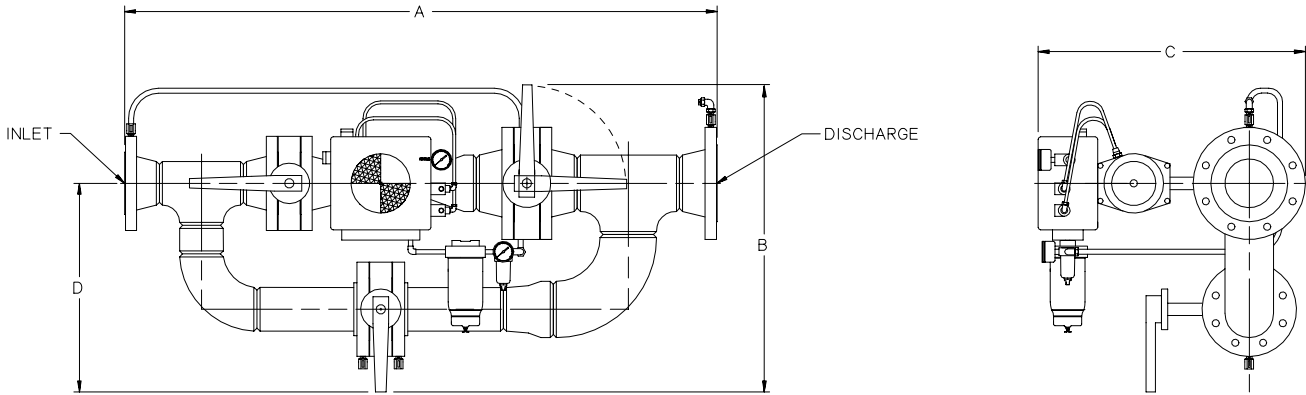

**ELECTRONIC
CONTROL PANEL**

Model No.	Inlet	Discharge	Max scfm	Weight lbs.	Approx. Dimensions (inches)			
					A	B	C	D
QSFC 1 x 2	1" ANSI	2" ANSI	300	70 lb	31.50"	16.25"	17.00"	11.50"
QSFC 1.5 x 2	1.5" ANSI	2" ANSI	500	80 lb	35.50"	18.25"	18.50"	13.25"
QSFC 2 x 3	2" ANSI	3" ANSI	800	175 lb	41.00"	29.12"	16.88"	18.50"
QSFC 3 x 4	3" ANSI	4" ANSI	1800	306 lb	47.25"	31.36"	18.72"	20.74"
QSFC 4 x 6	4" ANSI	6" ANSI	3000	459 lb	56.60"	35.86"	21.38"	25.24"
QSFC 5 x 6	5" ANSI	6" ANSI	6000	C/F	60.85"	35.86"	21.88"	25.25"
QSFC 6 x 8	6" ANSI	8" ANSI	8000	692 lb	67.48"	41.37"	24.43"	29.62"

Note:

- 1) Flanges are class 150 with raised gasket face
- 2) Maximum Inlet Pressure – 200 psig
- 3) For information on automatic bypass, backpressure control, pneumatic, large capacity dual-valve and other custom valve configurations and options – please consult factory
- 4) The maximum flow is based on a one psid control differential. Consult factory with turn-down greater than 10:1.

Quincy Systems Capabilities

Engineered for your compressed air system, Quincy's complete line of analysis services and compressed air products will optimize your system. Whether you're installing a new compressed air system – or upgrading your existing system – every Quincy component has been designed for maximum productivity. Backed by Quincy innovation and reliability – let Quincy Systems work for you.

Quincy Compressor®

Quincy Systems

